

## Fire Alarm System Conventional User-Friendly Wall-Mounted Addressable Fire Alarm System with Touch Panel Display and LCD Screen for Easy Operation Fire Safety Alarm System

Our Product Introduction

### Basic Information

- Place of Origin: China
- Brand Name: XHA
- Certification: CE
- Model Number: CA200
- Minimum Order Quantity: 1PCS
- Price: negotiable
- Packaging Details: 1PCS/Carton
- Delivery Time: 7 Working days
- Payment Terms: T/T, Western Union
- Supply Ability: 500pcs/month



### Product Specification

- Installation: Wall Mounted
- Humidity:  $\leq 95\%$
- Alarm System: Addressable Fire Alarm System
- Power Supply: AC90-270V
- LCD: Colored, Touch Panel Customized Request
- Wiring Mode: Non-Polarity 2 Wired
- Temperature:  $-10^{\circ}\text{C} \sim +50^{\circ}\text{C}$
- Capacity: 1-6 loops (254 points/loop)
- Number Of Detectors: Max. 1524 points
- Type: Networkable
- Humidity:  $\leq 95\%$



### More Images



for more products please visit us on [xhafiresafety.com](http://xhafiresafety.com)

## Product Description

### Wall-Mounted Addressable Fire Alarm System With Touch Panel Display And LCD Screen



### Introduction

Addressable fire alarm control panels are a type of fire alarm system that use a digital communication network to monitor and control various devices throughout a building or facility. Unlike conventional fire alarm systems that use hardwired connections, addressable systems utilize a central control panel that communicates with individual devices such as smoke detectors, pull stations, and notification appliances.

The key feature of an addressable fire alarm system is that each device has a unique digital address or identifier. This allows the control panel to communicate with and monitor the status of each device individually. Some key benefits of addressable fire alarm panels include:

**Improved Diagnostics:** The control panel can provide detailed information about the status and location of each device, making it easier to quickly identify and troubleshoot any issues.

**Flexibility:** Addressable systems allow for easier expansion and reconfiguration of the fire alarm system as building needs change over time.

**Enhanced Monitoring:** The control panel can provide more detailed information about device status, such as whether a smoke detector is in alarm, trouble, or maintenance mode.

**Reduced Wiring:** Addressable systems typically use a signaling line circuit (SLC) to connect multiple devices back to the control panel, reducing the amount of wiring required compared to conventional systems.

### Parameters

Product Name	Addressable Fire Alarm Control Panel	Capacity	1-1524 control points, maximum 6 loops
Capacity	Maximum 6 loops	Main power supply	AC220V±15%, 2.5A, 50HZ.
Battery power supply	DC 24V (2 sealed batteries: 2*12V*7Ah)	Loop Bus wired	Non-polarity 2 wired.
LCD	Touch panel, Networkable, Colored LCD	Operating Environment	Temperature -10°C~+50°C Humidity ≤95%.
Dimensions	400mm×500mm×125mm.	Certification	CE

### Main Functions

1. System self-test function. The system will test indicator light, LCD screen, sounder etc.
2. Inquiry function. Check model type zone number, device definition etc.
3. Event record. Record the fire alarm information and other operation record.

4. Data sampling. Data analysis.
5. Setting function. Set the password, time, printer information.
6. Install and programming. Address coding, Login, Logical programming
7. Feedback function. Give real-time feedback information after starting the equipment.
8. Faulty alarm function. Automatically check the working status of main power supply, battery power supply, detectors , modules and report the detail fault information.

### Connection Diagram

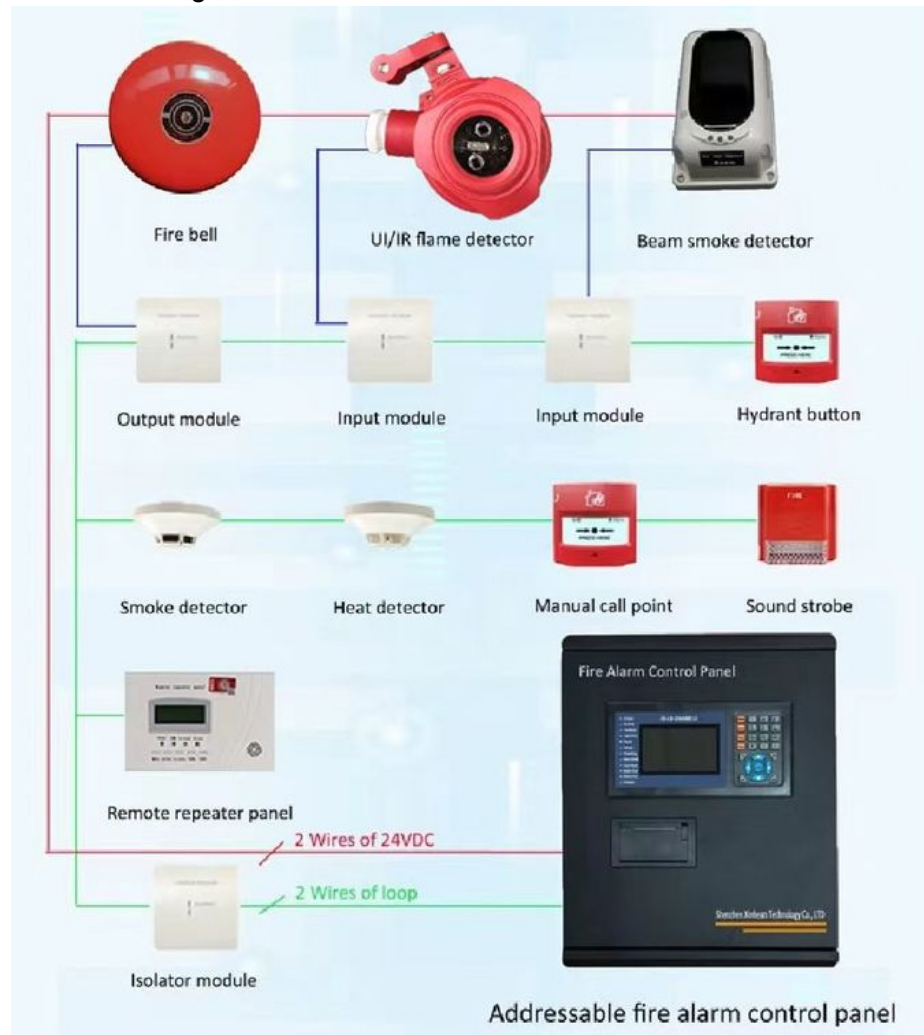

### Product Range

- Conventional Fire Alarm System
- Addressable fire alarm system
- Gas Extinguishing control system
- Beam Detector
- 4 wire smoke detectors with relay output.
- 2 wire Conventional smoke and heat detectors
- Explosion-proof flame detector for fire alarm system
- Standalone smoke detectors and combustible gas detector

### Service

1. OEM & ODM service.
2. Provide special technical support and after-sale service.
3. 1 year warranty.
4. Normally 15 working days lead time.
5. Welcome sample order.



**Shenzhen Xinhe'an Technology Co., Ltd.**



+8615986702194



Claire.tian@xinheantech.com



xhafiresafety.com

406,Jude Building,Zhengfeng South Road,Fuyong Street,Bao'An District, Shenzhen City, Guangdong Province.  
China,518103