



Intelligent Addressable Fire Alarm System With Manual Call Point For Customer Requirements

Our Product Introduction

for more products please visit us on xhafiresafety.com

Basic Information

- Place of Origin: China
- Brand Name: XHA
- Certification: CE
- Model Number: CA9006
- Minimum Order Quantity: 1PCS
- Price: negotiable
- Packaging Details: 200pcs/carton
- Delivery Time: 3 Working days
- Payment Terms: T/T, Western Union
- Supply Ability: 5000PCS/Month



Product Specification

- Product: Smoke Alarm Call Point
- Alarm Output: Sound/Light
- Input Voltage: 24VDC
- Humidity: 10% To 95% Non-condensing
- Communication Protocol: Addressable
- Product Application: Fire Alarm System
- Storage Temperature: -10°C To +50°C
- Warranty: 1 Year
- Highlight: Intelligent Addressable Fire Alarm System , Manual Call Point Fire Alarm System



More Images



Product Description

Product Description



Product Summary

An addressable pull station, also known as an addressable fire alarm call point, is a manually activated device used in fire alarm systems to initiate a fire alarm signal.

The key features of an addressable pull station are:

Addressability:

Each pull station has a unique digital address that is recognized by the fire alarm control panel. This allows the control panel to identify the exact location of an activated pull station.

Manual Activation:

The pull station has a breakglass or push-button mechanism that a person can physically interact with to trigger the fire alarm.

This provides a manual means of activating the alarm in the event of a fire or emergency.

Signaling the Fire Alarm System:

When activated, the pull station sends a signal to the fire alarm control panel, which then initiates the overall fire alarm response.

This includes sounding audible alarms, activating visual strobes, and potentially triggering other safety systems like fire sprinklers.

Reset Functionality:

After being activated, the pull station can usually be reset and returned to its normal, inactive state by authorized personnel.

This allows the fire alarm system to be restored once the emergency situation has been resolved.

Indicator Lights:

Many addressable pull stations have LED lights that illuminate to visually indicate when the device has been activated.

The addressable nature of these pull stations provides several benefits, including the ability to quickly identify the location of a fire or emergency, enabling a more coordinated and effective emergency response. Addressable pull stations are an essential component of modern, sophisticated fire alarm systems.

Technical Parameters

Product Type:	Fire Alarm System Manual Call Point
Alarm Output:	Sound/Light
Communication Protocol:	Addressable
Operating Humidity:	10-95%
Power Supply:	DC24V
Detection Method:	Smoke/Heat
Warranty:	1 Year
Operating Temperature:	-10-50 Degrees Celsius
Product Type:	Recoverable
Certifications:	EN54, CE

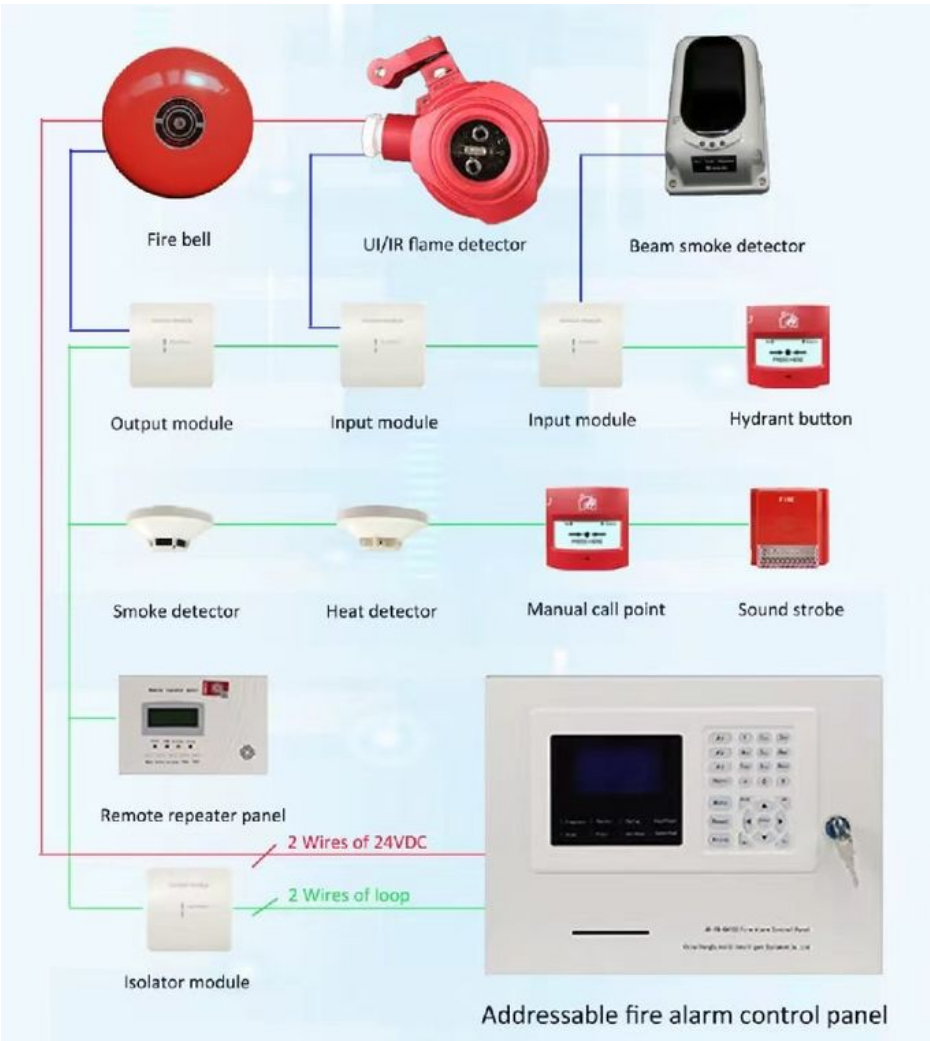

Addressable Fire Alarm System can be used in several scenarios, including but not limited to:

- Hotels
- Shopping malls
- Hospitals

Schools
Factories
Airports
Residential buildings

Product Range

Conventional Fire Alarm System
Addressable fire alarm system
Gas Extinguishing control system
Beam Detector
4 wire smoke detectors with relay output.
2 wire Conventional smoke and heat detectors
Explosion-proof flame detector for fire alarm system
Standalone smoke detectors and combustible gas detector



Shenzhen Xinhe'an Technology Co., Ltd.



+8615986702194



Claire.tian@xinheantech.com



xhafiresafety.com

406,Jude Building,Zhengfeng South Road,Fuyong Street,Bao'An District, Shenzhen City, Guangdong Province.
China,518103